



# Click to discover us

- 1** Legrand (India) - provides all information regarding the groups philosophy, products, organisation etc.
- 2** Products and solutions - complete information about our range of products for residential, commercial and industrial markets.
- 3** Downloads - download catalogues and brochures.

## snap-on trunking routing sections and accessories

TRUNKING			TRUNKING		
Number of compartments	Cover width	Cross-section (mm)	Monobloc: body + cover <sup>(1)</sup>	Divider	Fishplate body joint
<b>SNAP-ON TRUNKING - 45 mm cover</b>					
	45	50 x 80	○ 0756 01	0756 09	0756 61
	45	50 x 105	0756 02	0756 09	0756 62
	45 45	50 x 130	○ 0756 03	-	0756 61
	45 45	50 x 145	0756 04	-	0756 63
	45 45 45	50 x 180	0756 06	-	0756 61

1: Partition(s) integral to the body  
2: Internal and external corner angles supplied with multi-compartment partition joint

## mechanisms for snap-on trunking

### Mounting functions

The Arteor sockets to be fitted with Soluclip accessory which has following features:

- Anti-slip
- Anti-pullout
- IP 4X
- Perfect finish



0756 90

AND ACCESSORIES			ANGLES			JUNCTIONS				ACCESSORIES
Stick-on body joint	Cover joint	End cap	Internal angles <sup>(2)</sup>	External angles	Flat angles	Flat junctions with width 80 mm	Flat junctions with width 105 mm	Angled junctions 85/105/130 mm	Junction with floor duct 50 x 12/ 92 x 20	Extra cover
0756 66	0756 69	0756 11	0756 21	0756 31	0756 41	0756 71	-	0756 81 + 0756 21	0756 88	0756 08
0756 67	0756 69	0756 12	0756 22	0756 32	0756 42	0756 72	0756 76	0756 81 + 0756 22	0756 88	0756 08
0756 66	2 x 0756 69	0756 13	0756 23	0756 33	0756 43	0756 71	0756 75	0756 81 + 0756 23	0756 88	0756 08
① 0756 66 + ② 0756 67	2 x 0756 69	0756 14	0756 24	0756 34	0756 44	① 0756 71 + ② 0756 72	① 0756 75 + ② 0756 76	0756 81 + 0756 24	0756 88	0756 08
0756 66	3 x 0756 69	0756 16	0756 26	0756 36	0756 46	0756 71	0756 75	0756 81 + 0756 26	0756 88	0756 08

### Installation principle for sockets for snap-on trunking

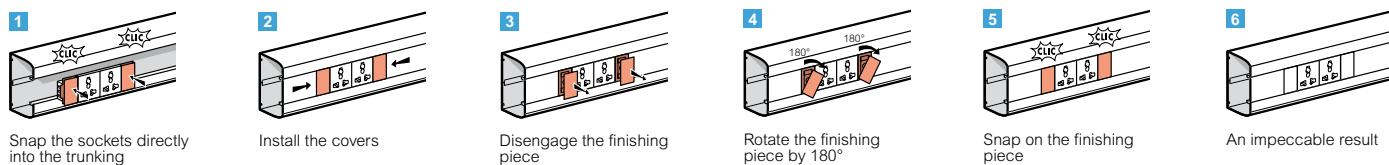

### Installation principle for Arteor functions

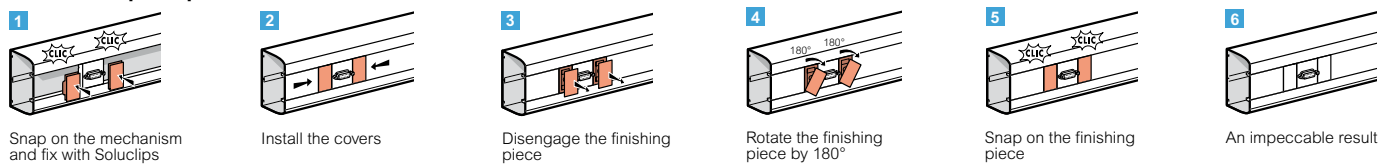

## DLP PVC adaptable trunking systems for installations base, covers, partitions, finishing accessories and mounting wiring accessories

Selection chart for Installation of trunking, Accessories and Arteor™

Trunking			Covers		Clip on partition		Arteor™ frames				
Number of compartments	Cover(s) width	Section (mm)									
			Flexible	Partitions separation	Plastic	Aluminium	1 module	2 module	3 module	4 module	6 module
 <b>0104 12</b>	1 	<b>80 x 50</b>	0105 21	0105 82	-	-	-	0109 21	0109 31	0109 41	0109 61
	2 		0105 20	0105 82	0104 72	0111 06	0109 10	-	-	-	-
 <b>0104 22</b>	1 	<b>105 x 50</b>	0105 22	0105 82	-	-	-	0109 22	0109 32	0109 42	0109 62
	2 		0105 20	0105 82	0104 72	0111 06	0109 10	-	-	-	-
	2 		0105 20 + 0105 22	0105 82	0104 72	0111 06	0109 10	0109 22	0109 32	0109 42	0109 62
	3 		0105 20	0105 82	0104 72 x 2	0111 06 x 2	0109 10	-	-	-	-
 <b>0104 32</b>	1 	<b>150 x 50</b>	0105 24	0105 82	-	-	-	-	-	-	-
	2 		0105 21	0105 82	0104 72	0111 06	-	0109 21	0109 31	0109 41	0109 61
	2 		0105 20 + 0105 22	0105 82	0104 72	0111 06	0109 10	0109 22	0109 32	0109 42	0109 62
	3 		0105 20	0105 82	0104 72 x 2	0111 06 x 2	0109 10	-	-	-	-
	1 		0105 26	0105 82	-	-	-	-	-	-	-
	2 		0105 22	0105 82	0104 72	0111 06	-	0109 22	0109 32	0109 42	0109 62
 <b>0104 52</b>	2 	<b>195 x 50</b>	0105 20 + 0105 24	0105 82	0104 72	0111 06	0109 10	-	-	-	-
	3 		0105 22 + 0105 20	0105 82	0104 72 x 2	0111 06 x 2	0109 10	0109 22	0109 32	0109 42	0109 62
	3 		0105 20 + 0105 21	0105 82	0104 72 x 2	0111 06 x 2	0109 10	0109 21	0109 31	0109 41	0109 61
	4 		0105 20	0105 82	0104 72 x 3	0111 06 x 3	0109 10	-	-	-	-

Selection chart for Installation trunking, Accessories and Arteor™

Section (mm)	Wall crossing	Capacity change	Partition junction	Cable tie base	Insulating unit for Arteor™ modules	Earth Link
80 x 50 / 105 x 50	0106 98	0106 87 + 0106 88 + 0106 89 (to be used for partition)	0106 89	0308 81		0111 88
150 x 50 / 195 x 50	0106 99					

### Selection chart for Installation of trunking, Additional accessories

Cover	Bases		Internal angles 80° - 100°			External angles 60° - 120°			Flat angles		Flat junction			
Joint for covers	Base joint	End caps	Angles	Partition junction	VDI access.	Angles	Partition junction	VDI access.	Angles	VDI access.	Angles	Partition junction	VDI access.	Clips
0108 01	0106 91	0107 22	0106 02	-	0107 80	0106 22	-	0107 81	0107 67	0107 82	0107 32	-	0107 83	0106 82
0108 02	0106 91	0107 02	0106 02	-	0107 80	0106 22	-	0107 81	0107 85	0107 82	0107 32	-	0107 83	0106 82
0108 00	0106 91	0107 02	0106 02	0106 11	-	0106 22	0106 32	-	-	-	0107 32	0107 42	-	0106 82
0108 04	0106 91	0107 06	0106 02	-	-	0106 22	-	-	0107 89	-	0107 32	-	-	0106 86
0108 01	0106 91	0107 06	0106 02	0106 11	0107 80	0106 22	0106 32	0107 81	0107 89	0107 82	0107 32	0107 42	0107 83	0106 82
0108 02	0106 91	0107 06	0106 02	0106 11	0107 80	0106 22	0106 32	0107 81	0107 89	0107 82	0107 32	0107 42	0107 83	0106 82
0108 00	0106 91	0107 06	0106 02	0106 11 x 2	-	0106 22	0106 32 x 2	-	0107 89	-	0107 32	0107 42	-	0106 82
0108 06	0106 91	0107 07	0106 02	-	-	0106 22	-	-	0107 92	-	0107 32	-	-	0106 86
0108 02	0106 91	0107 07	0106 02	0106 11	0107 80	0106 22	0106 32	0107 81	0107 92	0107 82	0107 32	0107 42	0107 83	0106 82
	0106 91	0107 07	0106 02	0106 11	0107 80	0106 22	0106 32	0107 81	0107 92	0107 82	0107 32	0107 42	0107 83	
	0106 91	0107 07	0106 02	0106 11 x 2	0107 80	0106 22	0106 32 x 2	0107 81	0107 92	0107 82	0107 32	0107 42	0107 83	0106 82
	0106 91	0107 07	0106 02	0106 11 x 2	0107 80	0106 22	0106 32 x 2	0107 81	0107 92	0107 82	0107 32	0107 42	0107 83	0106 82
0108 00	0106 91	0107 07	0106 02	0106 11 x 3	-	0106 22	0106 32 x 3	-	0107 92	-	0107 32	0107 42	-	0106 82

## DLP mini trunking systems for cable distribution

### ■ Selection chart for DLP mini trunking

	Length	Finishing Accessories				Junction Elements
WHITE	2 m	End cap	Internal angle	External angle	Flat angle	Flat junction
32 x 12.5	0300 15	0312 03	0302 51	0302 51	0302 53	0302 54
32 x 16	0308 04	0312 07	0333 25	0333 25	0333 27	0333 30
32 x 20	0300 17	0312 09	0302 71	0302 71	0302 73	0302 74



## DLP aluminium trunking system

selection chart of sections, covers and accessories  
selection chart of support for wiring accessories

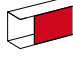
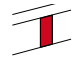
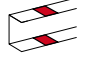
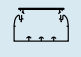
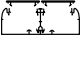
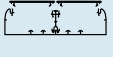
### TRUNKING AND ACCESSORIES

				Rigid covers 					Trunking 
Width (mm)	Nos. of compartments	Covers width	Cat. nos.	65 mm width	85 mm width	130 mm width	180 mm width		
105 x 50	1 	1 x 85	111 00	-	0111 11	-	-	0111 63	0111 66
150 x 50	2 	2 x 65	0111 02	2 x 0111 10	-	-	-	0111 62	0111 66
195 x 50	2 	2 x 85	0111 04	-	2 x 0111 11	-	-	0111 63	0111 66

### SUPPORT FOR WIRING ACCESSORIES

60 mm fixing centers : Arteur™	Cover depths	
No of module	65 mm	85 mm
2 modules 	0112 02	0112 12
3 modules 	0112 03	0112 13
4 modules 	0112 04	0112 14
6 modules 	0112 06	0112 16

Insulation resistance : the entire DLP range, including accessories, have insulation resistance above 5 Megaohms

## DLP TRUNKING SYSTEM ALUMINIUM

with aluminium adaptable  
DLP trunking,  
get better styling too !



### SELECTION CHART OF ACCESSORIES (continued)

Dividers		End cap	Internal angles	External angles	Flat angles	Junction Flat junction*	Clips	Earth link
Clip-on partition	Separation partition							
-	0111 08	0111 58	0112 21	0112 32	0112 43	0112 51	0106 82	0111 88
0111 06	0111 08	0111 60	0112 27	0112 38	0112 45	0112 51	0106 82	0111 88
0111 06	0111 08	0111 61	0112 29	0112 40	0112 47	0112 51	0106 82	0111 88

(1) To be used with angle covers. (2) To be used with rigid covers

### TABLE OF CAPACITIES

	Crosssection (mm <sup>2</sup> ) Max. Ø (mm <sup>2</sup> )	105 x 50	150 x 50		195 x 50	
		cover 85	cover 65	cover 65	cover 85	cover 85
Trunking only	Cross-section	4330	3020	3020	5350	5350
	Max. Ø	28	43	43	55	55
With Arteor™ / support	Cross-section	2300	1470	1470	3320	3320
	Max. Ø	2 x 24	18	18	33	33

\*To tap off 105 mm wide trunking with 85 mm cover



#### SAVE TIME

- Flexibility : multi-covers
- Removable separation
- Angles delivered pre-cut, ready to use
- Fast fixing device support
- Uniform colours for the entire installation
- Arteor™ wiring accessories go with aluminium adaptable DLP trunking

## Snap-on trunking routing sections and accessories

Cat.Nos	Description	MRP* ₹ / Unit	Pack
---------	-------------	------------------	------

### Snap-on trunking

**Monobloc: Body + Cover, can take any Arteor wiring accessory**

0756 01	Snap-on trunking 50 x 80 1 - compartment	902	20 <sup>(1)</sup>
0756 02	Snap-on trunking 50 x 105 1 - compartment	1146	12 <sup>(1)</sup>
0756 03	Snap-on trunking 50 x 130 2 - compartments	1578	12 <sup>(1)</sup>
0756 04	Snap-on trunking 50 x 145 2 - compartments	2034	8 <sup>(1)</sup>
0756 06	Snap-on trunking 50 x 180 3 - compartments	2242	8 <sup>(1)</sup>

### Divider

0756 09	Divider	194	26 <sup>(1)</sup>
---------	---------	-----	-------------------

### Extra cover

0756 08	Width 45 mm	348	20 <sup>(1)</sup>
---------	-------------	-----	-------------------

### Joints

#### Fishplate Body joint

0756 61	Set of 2 Body joints	314	10
0756 62	Set of 2 Body joints	416	10
0756 63	Set of 2 Body joints	364	10

#### Stick-on body joint

0756 66	For top part of body	204	20
0756 67	For bottom part of body	246	20

#### Cover joint

0756 69	Cover joint, width 45 mm	110	10
---------	--------------------------	-----	----

#### End caps

0756 11	Left or right end cap	182	10
0756 12	Left or right end cap	182	10
0756 13	Left or right end cap	300	5
0756 14	Left or right end cap	310	5
0756 16	Left or right end cap	340	5

#### Height spacer

0105 80	Colour charcoal grey for fitting 15 mm from the ground	456	24 <sup>(1)</sup>
---------	--	-----	-------------------

### Soluclip accessory

#### Fishplate body joint

0756 90	For installation with any Arteor function	156	10
---------	---	-----	----

### Angles

#### Internal angles

0756 21	varies from 80° to 100°	416	10
0756 22	varies from 80° to 100°	580	10
0756 23	varies from 80° to 100°	976	5
0756 24	varies from 80° to 100°	1568	5
0756 26	varies from 80° to 100°	1386	5

#### External angles

0756 31	varies from 85° to 120°	868	10
0756 32	varies from 85° to 120°	1332	10
0756 33	varies from 85° to 120°	1806	5
0756 34	varies from 85° to 120°	2126	5
0756 36	varies from 85° to 120°	2522	5

#### Flat angles

0756 41	Flat angle at 90°	508	10
0756 42	Flat angle at 90°	668	10
0756 43	Flat angle at 90°	1332	5
0756 44	Flat angle at 90°	1246	5
0756 46	Flat angle at 90°	2494	5

## Snap-on trunking routing sections and accessories

Cat.Nos	Description	MRP* ₹ / Unit	Pack
---------	-------------	------------------	------

### Junctions

#### Flat junctions with 80 mm width

0756 71	Creates a junction	698	5
0756 72	Creates a junction	698	5

#### For 105 mm wide upward trunking

0756 75	Creates a junction	684	5
0756 76	Creates a junction	746	5

#### Angled junction

Must be used in conjunction with an internal angle

0756 81	Creates a junction in an internal angle	1536	5
---------	---	------	---

#### Junction with floor duct

0756 88	Creates a junction with a floor duct size 50 x 12 mm or 92 x 20 mm	804	5
---------	--	-----	---

## DLP PVC trunking system Mini-trunking system

### Mini-trunking - 32 x 12.5 mm

0300 15	Without central partition	100	80 <sup>(1)</sup>
---------	---------------------------	-----	-------------------

### Finishing accessories

0312 03	End cap right or left	52	20/400
0302 51	Changeable internal - external angle from 60° to 120°	74	10/100
0302 53	Changeable flat angle from 85° to 95°	82	10/100
0302 54	Flat junction	104	10/200
0336 03	White 32 x 10/12.5 Cover Gasket	102	20

### Mini-trunking - 32 x 16 mm

0308 04	Without central partition	130	60 <sup>(1)</sup>
---------	---------------------------	-----	-------------------

### Finishing accessories

0312 07	End cap right or left	80	10
0333 25	Changeable internal - external angle from 60° to 120°	88	10
0333 27	Changeable flat angle from 85° to 95°	86	10
0333 30	Flat junction	122	10
0336 04	White 32 x 16/20 Cover Gasket	102	20

### Mini-trunking - 32 x 20 mm

0300 17	Without partition	138	50 <sup>(1)</sup>
---------	-------------------	-----	-------------------

### Finishing accessories

0312 09	End cap right or left	110	10
0302 71	Changeable internal - external angle from 60° to 120°	104	10
0302 73	Changeable flat angle from 85° to 95°	88	10
0302 74	Flat junction	102	10
0336 04	White 32 x 16/20 Cover Gasket	102	20

\* MRP - Maximum Retail Price Inclusive of all taxes including GST.  
(1) Price in Meters; No of meters in Pack, Standard length 2 meters to be ordered in multiples of 2 meters

Bold Cat.Nos are products normally available with Legrand (India) Stockists. Cat.Nos that are not bold - delivery within 4 - 8 weeks from the date of order. Bold packing quantity is our mandatory packing. Orders to be placed by Legrand (India) Stockist in multiples of the same.

## DLP PVC trunking system and accessories - trunking and fittings

Cat.Nos	Description	MRP* ₹ / Unit	Pack
---------	-------------	------------------	------

### Trunking

#### Bodies

Supplied without cover

0104 12	80 x 50 mm	570	20 <sup>(1)</sup>
0104 22	105 x 50 mm	708	20 <sup>(1)</sup>
0104 32	150 x 50 mm	1198	10 <sup>(1)</sup>
0104 52	195 x 50 mm	1586	8 <sup>(1)</sup>

#### Flexible cover

Fits onto the whole branch including in internal or external angles

0105 20	Full covers width 40 mm	280	20 <sup>(1)</sup>
0105 21	Full cover width 65 mm	274	24 <sup>(1)</sup>
0105 22	Full cover width 85 mm	316	20 <sup>(1)</sup>
0105 24	Full cover width 130 mm	668	8
0105 26	Full cover width 180 mm	850	8 <sup>(1)</sup>

#### Partitions

0105 82	Separation partition	186	24 <sup>(1)</sup>
0104 72	Clip-on partition - Plastic	274	48 <sup>(1)</sup>
0111 06	Clip-on partition - Aluminium	1076	12 <sup>(1)</sup>

#### Joints

0106 91	Body / Base joint - For aligning bases during installation	64	20/200
0108 00	Cover joint for 40 mm width	130	10/100
0108 01	Cover joint for 65 mm width	110	10/100
0108 02	Cover joint for 85 mm width	168	10/100
0108 04	Cover joint for 130 mm width	282	10/100
0108 06	Cover joint for 180 mm width	260	10/100

### Angles and end caps

#### Internal and external angles

Include the 2 components for the top and bottom of the trunking on which the flexible cover is fitted

0106 02	Internal angle, adjustable from 80° to 100°	402	10/40
0106 22	External angle, adjustable from 60° to 120°	392	10/50

#### Flat angle

0107 67	90° flat angle	554	10
0107 85	90° flat angle	580	10
0107 89	90° flat angle	1924	5
0107 92	90° flat angle	2470	2

#### End cap

0107 02	Left or right end cap	144	20/100
0107 06	Left or right end cap	280	10/50
0107 07	Left or right end cap	330	5/50
0107 22	Left or right end cap	156	10

### Junctions

0107 32	Flat junctions to tap-off to a branch smaller than 50 x 105	720	10
0107 35	For specific size tap-off to 80 mm wide branch	418	5
0107 36	For tap-off to an 105 mm wide branch equipped with an 85 mm cover	414	5/25
0107 37	Flat junction for specific size - tap off to an 105 mm wide branch with 65 mm cover	414	5/25

## DLP PVC trunking system and accessories - trunking and fittings

Cat.Nos	Description	MRP* ₹ / Unit	Pack
---------	-------------	------------------	------

### Junctions

#### Partition junction

0106 11	For internal angles	242	5/50
0106 32	For external angles	364	5/50
0107 42	For flat angles	860	5/25

### Accessories

#### Holding cables in place

0106 82	Clip for 65 mm width cover	56	50
0106 86	Clip for 130 mm width cover	96	50

#### VDI accessories

0107 80	For internal angles	622	5/50
0107 81	For external angles	670	5/50
0107 82	For flat angles	712	5/50
0107 83	For flat junctions	856	5/50

#### Additional accessories

0106 98	Wall crossing for trunking 80 to 150 mm width	690	5/25
0106 99	Wall crossing for trunking 195 mm width	718	5/25
0308 81	Cable tie base	24	100/1000
0111 88	Earthing link	260	20/500

### Capacity Change

Allows to increase 15 mm height of trunking to preserve the space of wiring with a flat junction or a support equipment

0106 87	Raise, length 57 cm	248	40
0106 88	Set of 4 accessories to change capacity of the body	312	10/100
0106 89	Set of 2 accessories to change height of partition (to be used)	314	5/50

### Supports for mounting wiring accessories

#### Arteor™ supports

Clip-on supports which can be fitted side by side  
Supplied with finishing plate

0109 10	1 modules-for 40 mm cover	142	5/50
0109 21	2 modules-for 65 mm cover	136	20
0109 22	2 modules-for 85 mm cover	140	20
0109 31	3 modules-for 65 mm cover	190	5/50
0109 32	3 modules-for 85 mm cover	202	5/50
0109 41	4 modules-for 65 mm cover	206	10/50
0109 42	4 modules-for 85 mm cover	206	20
0109 61	6 modules-for 65 mm cover	242	5/25
0109 62	6 modules-for 85 mm cover	272	10
0109 27	Insulation unit for 2 modules (Arteor™) can be fitted together to create 4/6/8 module supports	244	10/100

#### Legrand Lexic supports

0109 25	For 2 modules for 65 mm cover (2 comp.)	846	5
0109 35	For 3 modules for 85 mm cover (2 comp.)	1002	5
0109 65	For 6 modules for 130 mm cover (1 comp.)	1124	5
0109 00	Hydra socket support - for 130 mm cover	1626	5

\* MRP - Maximum Retail Price Inclusive of all taxes including GST.

(1) Price in Meters; No of meters in Pack, Standard length 2 meters to be ordered in multiples of 2 meters

Bold Cat.Nos are products normally available with Legrand (India) Stockists. Cat.Nos that are not bold - delivery within 4 - 8 weeks from the date of order. Bold packing quantity is our mandatory packing. Orders to be placed by Legrand (India) Stockist in multiples of the same.



## DLP-S PVC trunking system and accessories - trunking and fittings

Cat.Nos	Description	MRP* ₹ / Unit	Pack
---------	-------------	------------------	------

### Trunking

#### Body with cover

6380 38	100 x 50	830	12 <sup>(1)</sup>
---------	----------	-----	-------------------

#### Partition

6380 08	Separation Partition	152	32 <sup>(1)</sup>
---------	----------------------	-----	-------------------

#### Joints

6380 36	Body / Base Joint	52	10
6380 01	Cover joint	138	50

### Angles and end caps

#### Variable angles

6380 31	Variable Internal Angle	320	10
6380 32	Variable External Angle	320	10

#### Fixed angles

6380 11	Fixed Internal Angle	206	20
6380 12	Fixed External Angle	208	20

#### Flat angle

6380 13	Flat Angle	454	16
---------	------------	-----	----

#### End cap

6380 35	End Cap	118	20
---------	---------	-----	----

#### Bracket

6380 05	Universal Bracket (set of 2 pcs.)	102	10/100
---------	--------------------------------------	-----	--------

#### Junction

6380 34	Tee / Flat Junction	1000	5
---------	---------------------	------	---

### Supports for mounting wiring accessories

#### Arteor™ & Myrius supports

Clip-on supports which can be fitted side by side  
Supplied with finishing plate

6380 71	2 modules frame	146	10
6380 72	4 modules frame	202	5
6380 73	6 modules frame	292	5

## DLP aluminium adaptable trunking system

### Body

0111 00	Supplied without cover	3488	8 <sup>(1)</sup>
0111 02	Supplied without cover Allow fitting of partial covers - 2 compartments	4392	4 <sup>(1)</sup>
0111 04	Supplied without cover allow fitting of partial covers - 2 compartments	5150	4 <sup>(1)</sup>

### Cover and partition

0111 10	Rigid cover 65 mm width	868	16 <sup>(1)</sup>
0111 11	Rigid cover 85 mm width	1138	16 <sup>(1)</sup>
0111 08	Separation partition	600	24 <sup>(1)</sup>
0111 06	Clip on Partition	1076	12 <sup>(1)</sup>

### Finishing accessories

0111 66	Base / Body joint	204	20/100
0111 62	Cover joint - 65 mm	282	10
0111 63	Cover joint - 85 mm	300	10/100
0111 58	End cap	614	20/100
0111 60	End cap	1316	10
0111 61	End cap	1560	10
0112 43	Flat angle for 85 mm cover	5292	10
0112 45	Flat angle for cover 65/130 mm	8910	5

\* MRP - Maximum Retail Price Inclusive of all taxes including GST.  
(1) Price in Meters; No of meters in Pack, Standard length 2 meters to be ordered in multiples of 2 meters

## DLP aluminium adaptable trunking system - trunking and fittings

Cat.Nos	Description	MRP* ₹ / Unit	Pack
---------	-------------	------------------	------

### Finishing accessories

0112 47	Flat angle for cover 85/180 mm	9188	2
0112 32	External angle for 85 mm cover	6598	1
0112 38	External angle 2 cover 65 mm	13660	1
0112 40	External angle 2 covers 85mm	14264	1
0112 21	Internal angle for 85 mm cover	5936	1
0112 27	Internal angle 2 Covers 65 mm	13560	1
0112 29	Internal angle 2 Cover 85 mm	14162	1
0112 51	Flat junction To tap off to 105 mm wide trunking equipped with 85 mm cover	7182	5

### Supports for Arteor™ for cover 85 mm width

0112 12	2 modules	430	20
0112 13	3 modules	504	20
0112 14	4 modules	506	20
0112 16	6 modules	674	10

### Supports for Arteor™ for cover 65 mm width

0112 02	2 modules	390	20
0112 03	3 modules	478	20
0112 04	4 modules	496	20
0112 06	6 modules	582	10

### Cabling accessories

0106 82	Clip for 65 mm and 85 mm covers	56	50
0111 88	Earth link	260	20
0308 81	Base for cable ties	24	100

### Aluminium snap-on columns

#### Columns

##### 74 x 80 mm - 1 compartment

6038 00	Height 2.70 m Can be adapted to a ceiling height up to 3.70 m	23800	1
6038 02	Height 3.70 m Can be adapted to a ceiling height up to 4.70 m	27788	1

##### 81 x 130 mm - 2 compartments

6038 01	Height 2.70 m Can be adapted to a ceiling height up to 3.70 m	32974	1
6038 03	Height 3.70 m Can be adapted to a ceiling height up to 4.70 m	38846	1

### Separation partition for 74 x 80 and 81 x 130 Snap-on columns

6038 07	Height 60 mm	436	36 <sup>(1)</sup>
---------	--------------	-----	-------------------

### Mini-column

6038 05	81x130mm - 2 compartments Height 0.68 m Can be associated with floor trunking range	13668	1
---------	--	-------	---

### Other accessories

0111 88	Accessory - Earth Link	260	20
6038 57	Fixing CLIP- Signal White (Set of 2pcs)	194	10
6038 58	Fixing CLIP - Grey / Anthracite (Set of 2pcs)	548	10

Bold Cat.Nos are products normally available with Legrand (India) Stockists.  
Cat.Nos that are not bold - delivery within 4 - 8 weeks from the date of order.  
Bold packing quantity is our mandatory packing. Orders to be placed by  
Legrand (India) Stockist in multiples of the same.